

# 公共施設及び区画別求積図

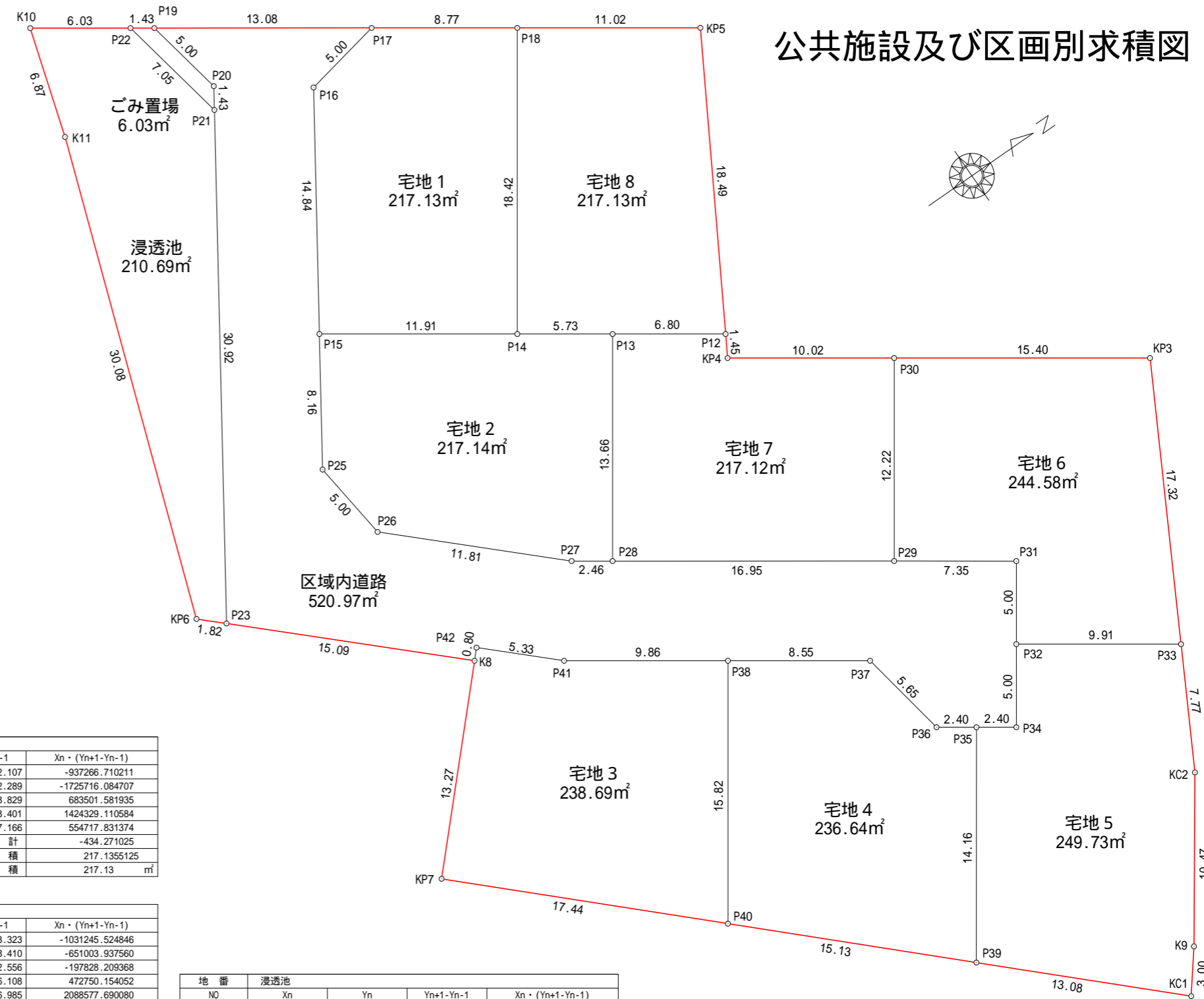
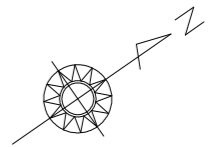

地番	宅地 1			
NO	Xn	Yn	Yn+1-Yn-1	Xn · (Yn+1-Yn-1)
P17	77408.316	12446.958	-4.068	-314897.029488
P16	77403.402	12447.899	13.323	1031245.524846
P15	77395.207	12460.281	19.191	1485291.417537
P14	77404.984	12467.090	-8.314	-643545.036976
P18	77415.515	12451.967	-20.132	-1558529.147980
合計				-434.272061
合計面積				217.1360305
地積				217.13 m <sup>2</sup>

地番	宅地 2			
NO	Xn	Yn	Yn+1-Yn-1	Xn · (Yn+1-Yn-1)
P13	77409.689	12470.368	-14.495	-1122053.442055
P14	77404.984	12467.090	-10.087	-780784.073608
P15	77395.207	12460.281	-0.002	-154.790414
P25	77390.701	12467.088	11.779	911585.067079
P26	77391.272	12472.060	13.087	1012819.576664
P27	77399.853	12480.175	9.525	737233.599825
P28	77401.878	12481.585	-9.807	-759080.217546
合計				-434.280055
合計面積				217.1400275
地積				217.14 m <sup>2</sup>

地番	宅地 3			
NO	Xn	Yn	Yn+1-Yn-1	Xn · (Yn+1-Yn-1)
P38	77404.148	12490.479	-18.625	-1441652.256500
P41	77396.053	12484.842	-9.301	-719860.688953
P42	77392.179	12481.178	-3.082	-238522.695678
K8	77391.627	12481.760	10.223	791174.602821
KP7	77382.500	12491.401	21.707	1679741.927500
P40	77395.103	12503.467	-0.922	-71358.284966
合計				-477.395776
合計面積				238.6978880
地積				238.69 m <sup>2</sup>

地番	宅地 4			
NO	Xn	Yn	Yn+1-Yn-1	Xn · (Yn+1-Yn-1)
P38	77404.148	12490.479	8.099	626896.194652
P40	77395.103	12503.467	23.458	1815534.326174
P39	77406.039	12513.937	-1.155	-89403.975045
P35	77414.136	12502.312	-12.998	-1006228.939728
P36	77412.165	12500.939	-6.944	-537550.073760
P37	77411.168	12495.368	-10.460	-809720.817280
合計				-473.284987
合計面積				236.6424935
地積				236.64 m <sup>2</sup>

地番	宅地 5			
NO	Xn	Yn	Yn+1-Yn-1	Xn · (Yn+1-Yn-1)
P33	77427.103	12505.246	-12.485	-966677.380955
P32	77418.964	12499.579	-1.562	-120928.421768
P34	77416.106	12503.684	2.733	211578.217698
P35	77414.136	12502.312	10.253	793727.136408
P39	77406.039	12513.937	20.676	1600447.262364
KC1	77415.493	12522.988	6.685	517522.570705
K9	77417.341	12520.622	-10.924	-845707.033084
KC2	77423.376	12512.064	-15.376	-1190461.829376
合計				-499.478008
合計面積				249.7390040
地積				249.73 m <sup>2</sup>

地番	宅地 6			
NO	Xn	Yn	Yn+1-Yn-1	Xn · (Yn+1-Yn-1)
P33	77427.103	12505.246	-9.535	-738267.427105
KP3	77435.413	12490.044	-24.003	-1858682.218239
P30	77422.774	12481.243	1.228	95075.166472
P29	77415.790	12491.272	14.231	1101704.107490
P31	77421.823	12495.474	8.307	643143.083661
P32	77418.964	12499.579	9.772	756538.116208
合計				-489.171513
合計面積				244.5857565
地積				244.58 m <sup>2</sup>

地番	宅地 7			
NO	Xn	Yn	Yn+1-Yn-1	Xn · (Yn+1-Yn-1)
P30	77422.774	12481.243	-15.761	-1220260.341014
KP4	77414.544	12475.511	-6.987	-540895.418928
P12	77415.273	12474.256	-5.143	-398146.749039
P13	77409.689	12470.368	7.329	567335.610681
P28	77401.878	12481.585	20.904	1618008.857712
P29	77415.790	12491.272	-0.342	-26476.200180
合計				-434.240768
合計面積				217.1203840
地積				217.12 m <sup>2</sup>

地番	宅地 8			
NO	Xn	Yn	Yn+1-Yn-1	Xn · (Yn+1-Yn-1)
P12	77415.273	12474.256	-12.107	-937266.710211
KP5	77424.563	12458.261	-22.289	-1725716.084707
P18	77415.515	12451.967	8.829	683501.581935
P14	77404.984	12467.090	18.401	1424329.110584
P13	77409.689	12470.368	7.166	554717.831374
合計				-434.271025
合計面積				217.1355125
地積				217.13 m <sup>2</sup>

地番	区域内道路			
NO	Xn	Yn	Yn+1-Yn-1	Xn · (Yn+1-Yn-1)
P16	77403.402	12447.899	-13.323	-1031245.524846
P17	77408.316	12446.958	-8.410	-651003.937560
P19	77397.578	12439.489	-2.556	-197828.209368
P20	77398.519	12444.402	6.108	472750.154052
P21	77397.728	12445.597	26.985	2088577.690080
P23	77380.658	12471.387	36.163	2798316.735254
K8	77391.627	12481.760	9.791	757741.419957
P42	77392.179	12481.178	3.082	238522.695678
P41	77396.053	12484.842	9.301	719860.688953
P38	77404.148	12490.479	10.526	814756.061848
P37	77411.168	12495.368	10.460	809720.817280
P36	77412.165	12500.939	6.944	537550.073760
P35	77414.136	12502.312	2.745	212501.803320
P34	77416.106	12503.684	-2.733	-211578.217698
P32	77418.964	12499.579	-8.210	-635609.694440
P31	77421.823	12495.474	-8.307	-643143.083661
P29	77415.790	12491.272	-13.889	-1075227.907310
P28	77401.878	12481.585	-11.097	-858928.640166
P27	77399.853	12480.175	-9.525	-737233.599825
P26	77391.272	12472.060	-13.087	-1012819.576664
P25	77390.701	12467.088	-11.779	-911585.067079
P15	77395.207	12460.281	-19.189	-1485136.627123
合計				-1041.945558
合計面積				520.9727790
地積				520.97 m <sup>2</sup>

地番	浸透池			
NO	Xn	Yn	Yn+1-Yn-1	Xn · (Yn+1-Yn-1)
P21	77397.728	12445.597	-32.716	-2532144.069248
P22	77396.402	12438.671	-10.374	-802910.274348
K10	77391.446	12435.223	3.123	241693.485858
K11	77389.424	12441.794	34.909	2701587.402416
KP6	77379.330	12470.132	29.593	2289886.512690
P23	77380.658	12471.387	-24.535	-1898534.444030
合計				-421.386662
合計面積				210.6933310
地積				210.69 m <sup>2</sup>

地番	ゴミ置場			
NO	Xn	Yn	Yn+1-Yn-1	Xn · (Yn+1-Yn-1)
P20	77398.519	12444.402	-6.108	-472750.154052
P19	77397.578	12439.489	-5.731	-443565.519518
P22	77396.402	12438.671	6.108	472737.223416
P21	77397.728	12445.597	5.731	443566.379168
合計				-12.070986
合計面積				6.0354930
地積				6.03 m <sup>2</sup>

※確定測量前の求積図につき  
確定測量後面積に差異が生じますので、  
予めご了承ください。